

## Afterburner Replacement

### First Step- Unplug the roaster



Remove right and left side panels : 6 screws right side- 7 screws on the left -extra one is found by opening door and look on the interior side of the left panel



Remove four screws- orange arrows

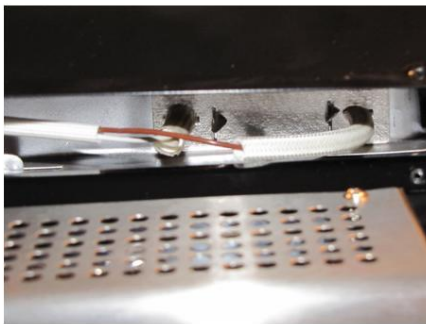

Gently raise the back panel up about 1.5"- DO NOT over-stress or raise too high- You'll see the above.  
\*\* You can prop it open with a small item of 1.5" height



Slide the sheathing back to expose the two clips- a blow up is below

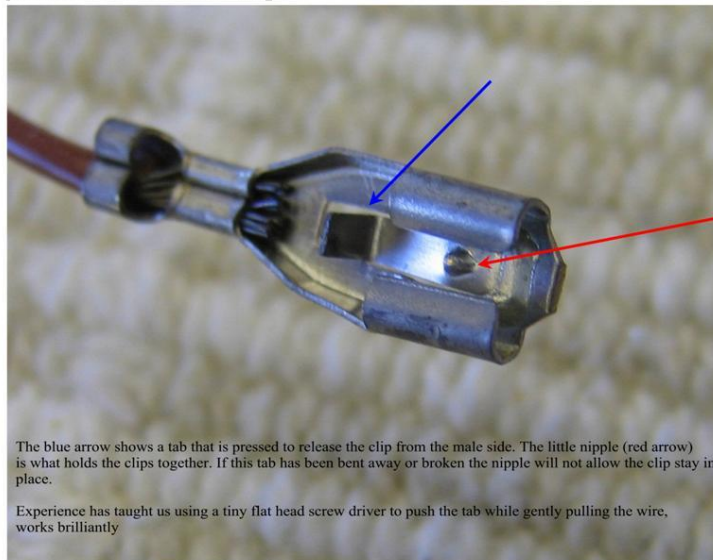

The blue arrow shows a tab that is pressed to release the clip from the male side. The little nipple (red arrow) is what holds the clips together. If this tab has been bent away or broken the nipple will not allow the clip stay in place.

Experience has taught us using a tiny flat head screw driver to push the tab while gently pulling the wire, works brilliantly

As noted take a small flat head screw driver and press the clips tab (blue arrow) so the clip can be gently pulled away from the connection-repeat for the second. Next step is the interior as shown in the other email file.

## Afterburner Replacement- cont.

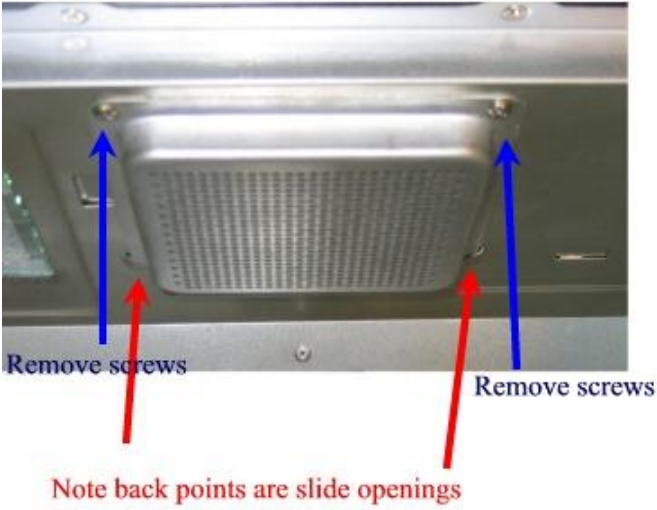

then slide towards you when you have clearance till it can drop as seen below

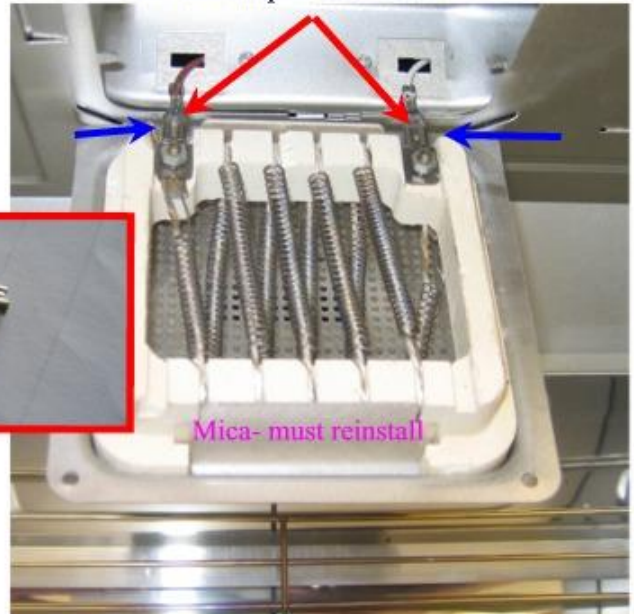

disconnect leads at the clip- clip has tiny press release by red arrows----- do reverse to install



Gently pull down..